



Alex



36, Alban Street, New Broughton, Salford, M7 1NQ

This modern three storey three bedroom town house is located in the new district of New Broughton in Salford a Countryside Development. Entrance hall with access to the garage and the third bedroom which has en-suite shower. On the first floor there is a spacious living/kitchen room with Juliet balcony. On the second floor two further bedrooms can be found one with en-suite and a further family bathroom. UPVC double glazing and gas central heating. Off road parking and enclosed rear garden.

Asking Price £315,000

Viewing arrangements

Viewing strictly by appointment through the agent

245 Deansgate, Manchester, M3 4EN 0161 833 9499 opt 3

Entrance Hall

Staircase leading to the first floor. Access to the garage. Door to bedroom Three.

Bedroom Three

9'10" x 8'8"

Upvc double glazed double doors to the rear garden. Single radiator. Door to

En-Suite

7'2" x 5'7"

Upvc double glazed window. Wash hand basin, w.c corner shower cubicle, Single radiator.

Garage

Double garage with up and over door.

First Floor

Upvc double glazed window. Staircase to second floor.

Living/Dining Room

16'4" x 15'0"

This spacious room has upvc double glazed windows and french doors. Double radiators, tv point.

Kitchen

9'4" x 8'2"

White high gloss wall and base units with stainless steel one and a half sink unit. Integral fridge/freezer, oven, gas hob, extractor hood. Plumbing for automatic washing machine. Upvc double glazed french doors.

Second Floor

Cupboard housing hot water heating system.

Master Bedroom

11'11" x 9'4"

Upvc double glazed window, tv point, double radiator

En-Suite

Upvc double glazed window, wash hand basin, wc and shower cubicle.

Bedroom Two

11'11" x 9'4"

Upvc double glazed window, tv point, double radiator

Bathroom

6'8" x 6'6"

Upvc double glazed window, wash hand basin, wc and bath with shower attachment.

Gardens

Driveway to the front. Enclosed rear garden with garden shed and access to the rear communal area.

Additional Information

Annual Service Charge- £371.64

Ground Rent- £100.00

Leasehold- 250 years from 2007

Council Tax Band- B

EPC - C

Agents Notes

To be able to purchase a property in the United Kingdom all agents have a legal requirement to conduct Identity checks on all customers involved in the transaction to fulfil their obligations under Anti Money Laundering regulations. We outsource this check to a third party and a charge will apply. Ask the branch for further details.

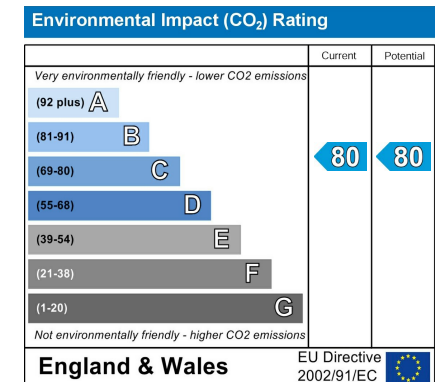
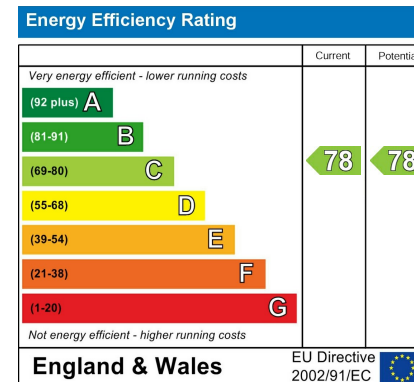



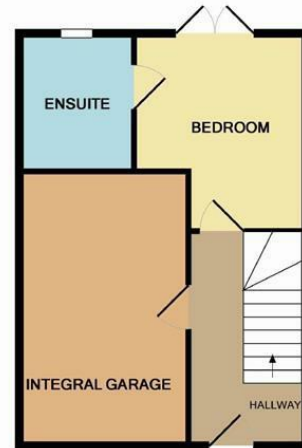

GROUND FLOOR

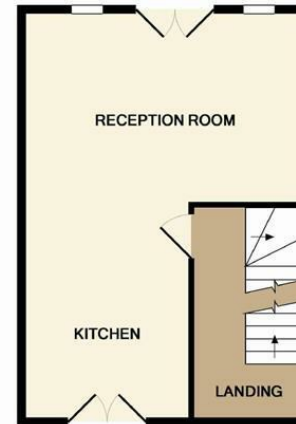

1ST FLOOR

Measurements are approximate. Not to scale. Illustrative purposes only.
Made with Metropix ©2012.

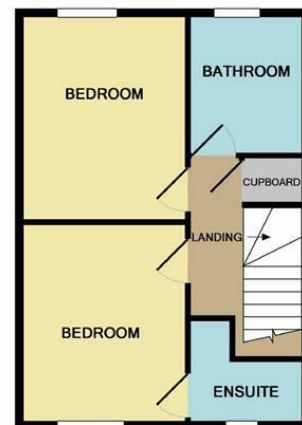

2ND FLOOR



These particulars are believed to be accurate but they are not guaranteed and do not form a contract. Neither Jordan Fishwick nor the vendor or lessor accept any responsibility in respect of these particulars, which are not intended to be statements or representations of fact and any intending purchaser or lessee must satisfy himself by inspection or otherwise as to the correctness of each of the statements contained in these particulars. Any floorplans on this brochure are for illustrative purposes only and are not necessarily to scale.

Offices at: Chorlton, Didsbury, Disley, Hale, Glossop, Macclesfield, Manchester Deansgate, Manchester Whitworth Street, New Mills, Sale, Wilmslow and Withington

245 Deansgate, Manchester, M3 4EN

0161 833 9499 opt 3

manchester@jordanfishwick.co.uk

www.jordanfishwick.co.uk

